

Remote Access Ports

Overview

Lapp Systems provides the key to continued productivity with a complete line of Remote Access Ports. These ports allow for easy access to a PLC or industrial computer device without compromising safety. Many configurations

are available for "standard" protocols while custom designs can be manufactured to suit any application. Pre-wired cable assemblies are also offered to insure proper component termination.

Before... "The Hard Way"

- Dangerous- Open Exposed Wire
- Safety Hazard
- Production Interruption

After.... "The Easy Way"

- Closed Panel
- Safe
- Production Continuity

UL E211786

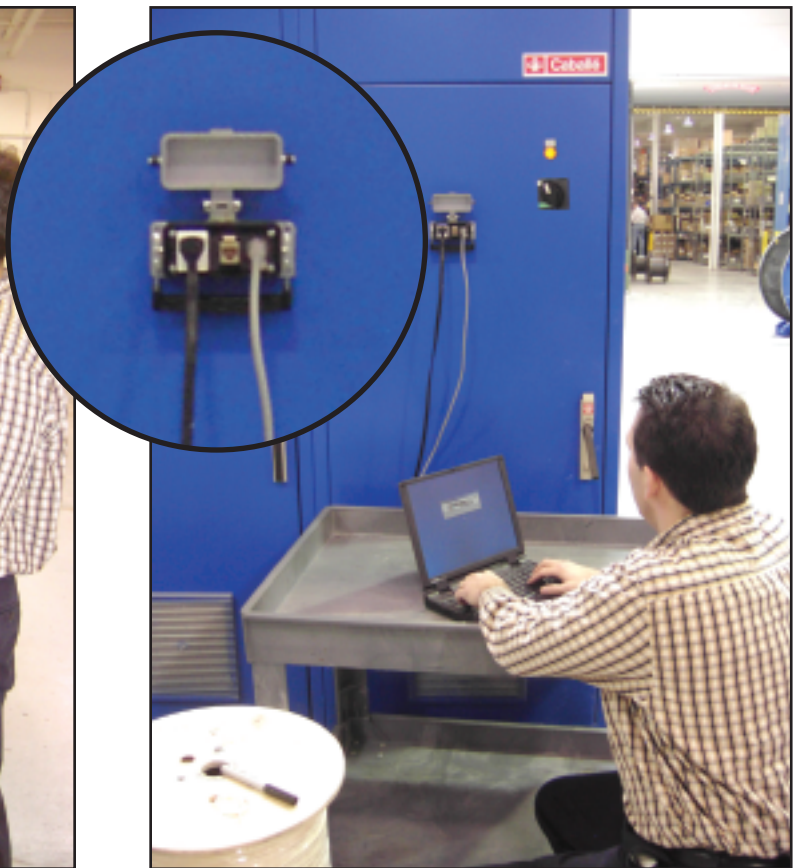

PROTOCOL CROSS REFERENCE

DB9= DH+, DH485, Serial, RS232, Serial Mouse, PLC 5, M984
 DB15= PLC2
 DB15H= Video, VGA
 DB 25= RS232, Parallel, Printer, PLC3
 RJ45= DH485, SLC 500, Ethernet, Control Net, 10 Base T

6 Pos. Mini Din= Keyboard, Mouse, PS/2
 8 Pos. Mini Din= Data Highway=, Enhanced PLC5, SLC 5/04
 5 Pos. Din= AT Style Keyboard
 8 Pos. Din= SLC100
 3 Pos. Header= Data Highway+

Remote Access Ports

Standard Configurations

Ethernet



Part # 48-2S-3A-45C5S

HBE 48 Enclosure: Duplex AC Outlet, CAT 5 RJ 45 Coupler, & 3 Amp Circuit Breaker

RS232



Part # 16-1-9XP

HBE 16 Enclosure: Single AC Outlet & DB 9 Gender to Gender Coupler

Data Highway



Part # 24-1-3A-9XP-MD8P

HBE 24 Enclosure: Single AC Outlet, 3 Amp Circuit Breaker, DB 9 Gender to Gender Coupler, & 8 Position Mini Din Coupler



SLC 500 DH485

Part # 16-1-45CS
HBE 16 Enclosure: Single AC Outlet & Shielded RJ45 Coupler

DH+

Part # 16-1-MD8P
HBE 16 Enclosure: Single AC Outlet & 8 Position Mini Din Coupler



RS232



Part # 48-2S-3A-9XP

HBE 48 Enclosure: Duplex AC Outlet, 3 Amp Circuit Breaker, & DB 9 Gender to Gender Coupler

SLC 500



Part # 6-45T

HBE 6 Enclosure: RJ45 Connector with Terminal Block Interface

CD Rom Unit

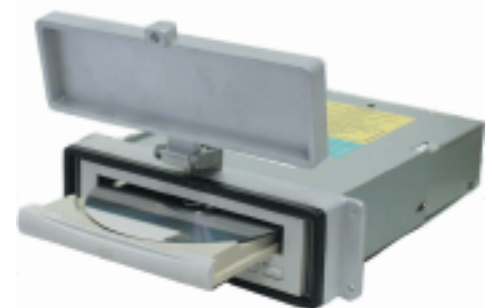

Part # 10.9000NCDR

Custom Enclosure Bracket set for CD-ROM or 5 1/4" protocol

**Many designs available
for IMMEDIATE delivery.**

Remote Access Ports

Standard Configurations

RS232



Part # 24-1-3A-9XP

HBE 24 Enclosure: Single AC Outlet, 3 Amp Circuit Breaker, DB 9 Gender to Gender Coupler

Computer Port



Part # 10-2MD6P

HBE 10 Enclosure: 2- 6 Position Mini Din Coupler

DH+



Part # 48-2S-3A-9XP-3H

HBE 48 Enclosure: Duplex AC Outlet, 3 Amp Circuit Breaker, DB 9 Gender to Gender Coupler, 3 Pos Header

RS232



Part # 6-9XP

HBE 6 Enclosure: DB 9 Gender to Gender Coupler

Device Net



Part # 24-1-3A-5H

HBE 24 Enclosure: Single AC Outlet, 3 Amp Circuit Breaker, 5P Header

USB 2.0 Interface



Part # 48-2S-3A-UFP

HBE 48 Enclosure: Duplex AC Outlet, 3 Amp Circuit Breaker & USB Interface Coupler



Part # 24-35ND

Remote Access Port with 3.5" Disk Drive Assembly bracket without drive

Select the gender of the D'subs.

Remote Access Ports

Standard Configurations

STANDARD REMOTE ACCESS PORTS

PART #:	DESCRIPTION:	INTERFACE PROTOCOLS:
6-11C	HBE 6 W/ RJ 11 COUPLER	MODEM INTFC
6-45CS	HBE 6 W/ RJ 45 SHIELDED COUPLER	DH485/ETHERNET/CONTROL NET/10 BASE T
10-1-45CS	HBE 10 W/ SINGLE AC OUTLET, RJ 45 SHIELDED COUPLER	DH485/ETHERNET/CONTROL NET/10 BASE T
10-1S-9MP	HBE 10 W/ SINGLE AC OUTLET (SLIM), DB 9 MALE TO MALE COUPLER	DH+/DH485/ASCII/DF1
16-9MP-MD6P	HBE 16 W/ DB 9 MALE TO MALE CPLR, 6 POS MINI DIN CPLR F-F	DH+
24-1-3A-MD6P	HBE 24 W/ SINGLE AC OUTLET, 3A CIRCUIT BRK, 6 POS MINI DIN CPLR F-F	DH+
24-1-45CS-9MP	HBE 24 W/ SINGLE AC OUTLET, RJ 45 SHIELDED CPLR, DB 9 MALE TO MALE COUPLER	DH+/DH485/ASCII/DF1/SERIAL/RS232/SERIAL MOUSE/ETHERNET/CONTROL NET/10 BASE T
32-2-3A-9FP	HBE 32 W/ DUPLEX AC OUTLET, 3A CIRCUIT BRK, DB 9 FEMALE TO FEMALE COUPLER	DH+/DH485/ASCII/DF1/SERIAL/RS232/SERIAL MOUSE
32-G2-9MP	HBE 32 W/ GFCI DUPLEX AC OUTLET, DB 9 MALE TO MALE COUPLER	DH+/DH485/ASCII/DF1/SERIAL/RS232/SERIAL MOUSE
32-2S-3A-45CS	HBE 32 W/ DUPLEX AC OUTLET (SCREW TERM), 3A CIRCUIT BRK, RJ 45 SHIELDED COUPLER	DH485/ETHERNET/CONTROL NET/10 BASE T
48-2S-29FP	HBE 48 W/ DUPLEX AC OUTLET (SCREW TERM), (2) DB9 FEM TO FEM COUPLERS	DH+/DH485/ASCII/DF1/SERIAL/RS232/SERIAL MOUSE
48-2S-3A-15FP	HBE 48 W/ DUPLEX AC OUTLET (SCREW TERM), 3A CIRCUIT BRK, DB 15 FEM TO FEM COUPLER	AB 9 SERIES - PLC-2 - GE FANUC SNP - SIEMENS CURRENT LOOP
48-2S-3A-25MP	HBE 48 W/ DUPLEX AC OUTLET (SCREW TERM), 3A CIRCUIT BRK, DB 25 MALE TO MALE COUPLER	PARALLEL DEVICE
48-2S-3A-MD6P	DUPLEX AC OUTLET, 3A CIRCUIT BRK, 6 PIN MIN DIN COUPLER	DH+
48-G2-9MP-45CS	GFCI DUPLEX AC OUTLET, DB 9 MALE TO MALE COUPLER, RJ 45 SHIELDED COUPLER	DH+/DH485/ASCII/DF1/SERIAL/RS232/SERIAL MOUSE/ETHERNET/CONTROL NET/10 BASE T

All ports are available with cable assemblies. Call factory for quote.

REMOTE ACCESS PORTS FOR PLC

PLC TYPE	RELATIVE PROTOCOLS	P/N W/ AC	P/N W/O AC
A-B PLC-5/10	· DB9F (PROGRAMMING TERMINAL) · 3P HEADER (DH+)	· 24-1-9FP-3H	· 16-9FP-3H
A-B PLC 5/12 & 5/15 & 5/25	· DB9F (PROGRAMMING TERMINAL) · 3P HEADER (DH+) · 3P HEADER (REMOTE I/O)	· 24-1-9FP-23H	· 16-9FP-23H
A-B PLC 5	· 8P MINI DIN (DH+) · 3P HEADER (DH+)	· 24-1-MD8P-3H	· 16-MD8P-3H
SLC 5/04	· 3P HEADER (DH+) · 8P MINI DIN (DH+) · DB9F (RS232/DH485)	· 24-1-3H-MD8P-9FP	· 16-3H-MD8P-9FP
SLC 5/03	· RJ45 (DH485) · DB9F (RS232/DH485)	· 24-1-45CS-9FP	· 16-45CS-9FP
SLC 5/02	· RJ45 (DH485)	· 16-1-45CS	· 6-45CS
SLC 5/01	· RJ45 (DH485)	· 16-1-45CS	· 6-45CS
SLC 500	· RJ45/TB INTFC (DH485)	· 16-1-45T	· 6-45T
A-B PANELVIEW 900	· DB9F (RS232)	· 16-1-9FP	· 6-9FP
A-B PANELVIEW 1200E/1400E	· DB9F (PROGRAMMING)	· 16-1-9FP	· 6-9FP
A-B CONTROL NET	· RJ45 (DH485)	· 16-1-45CS	· 6-45CS
A-B 1394	· DB9F (RS232)	· 16-1-9FP	· 6-9FP
A-B PLC 2	· DB15F	· 16-1-15FP	· 6-15FP
A-B DEVICE NET	· 5P HEADER	· 16-1-5H	· 10-5H
GE SNP	· DB9M	· 16-1-9MP	· 6-9MP
GE SNP	· DB15F	· 16-1-15FP	· 6-15FP
GE CNC	· PCR20M	· 16-1-20M	· 6-20M
SIEMENS CURRENT LOOP	· DB15F	· 16-1-15FP	· 6-15FP · 6-9FP
MODICON MODBUS	· DB9F	· 16-1-9FP	· 6-9MP
MODICON MODBUS + ALTERNATE NOTES	· DB9M TO APPLY DUPLEX TO APPLY CIRCUIT PROTECTION TO AC TO ADD CABLE ASSEMBLIES	· 16-1-9MP CHANGE PREFIX TO EITHER 32 OR 48 & CHANGE "1" TO "2" ADD 1A, 2A, 3A, 5A, OR 10A BETWEEN 1ST & 2ND P/N SEGMENTS ADD "-CXX (XX=LENGTH)	N/A N/A SAME

All ports are available with cable assemblies. Call factory for quote.



6-45CS



10-1-45CS

Remote Access Ports

Additional Information

PANEL MOUNT BASE DIMENSIONS

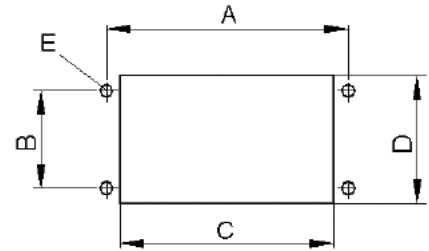
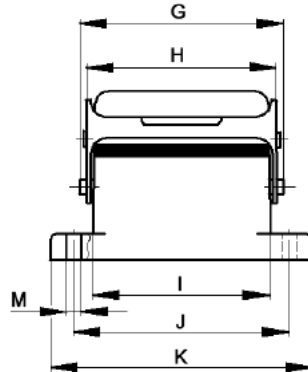
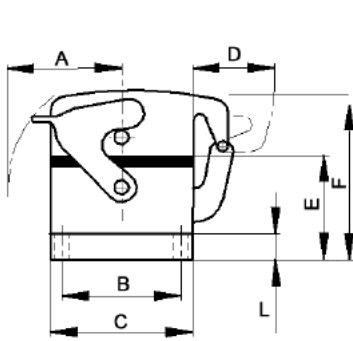

Series	A	B	C	D	E	F	G	H	I	J	K	L	M
HBE 6	44	32	43	25	27.8	44.8	74.8	70	60	70	80	4	4.3
HBE 10	50	32	43	25	27.8	44.8	91	88.5	73	83	93	4	4.3
HBE 16	50	32	43	25	27.8	44.8	111	109.5	93.3	103	113	4	4.3
HBE 24	50	32	43	25	27.8	44.8	138	136.5	120	130	140	4	4.3
HBE 32	57.7	65	90.2	17.8	32.7	45	112.8	105	88.3	110	124.3	6.2	4.85
HBE 48	105	70	90	30	39.5	56.5	152	139.5	132	148	165	10	7

Series	A	B	C	D	E
HBE 6	70	32	52.2	35	4.3
HBE 10	83	32	65.2	35	4.3
HBE 16	103	32	85.5	35	4.3
HBE 24	130	32	112.2	35	4.3
HBE 32	110	65	85.5	79	5.5
HBE 48	148	70	117	82	7

CABLE ASSEMBLY SUFFIX

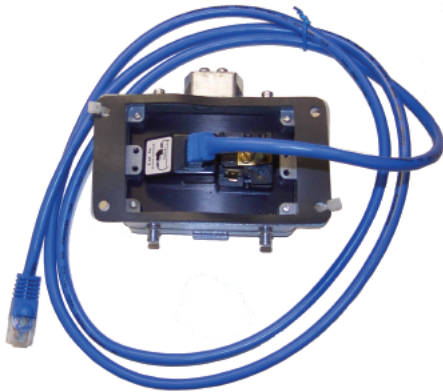

Type	Gender	Length	P/N Adder	Gender	Length	P/N Adder
DB 9	M-M	5	C9M5	M-F	5	C9MF5
		10	C9M10		10	C9MF10
HDB15	M-M	5	CH15M5	M-F	5	CH15MFH5
		10	CH15M10		10	CH15MFH10
DB15	M-M	5	C15M5	M-F	5	C15MF5
		10	C15M10		10	C15MF10
DB25	M-M	5	C25M5	M-F	5	C25MF5
		10	C25M10		10	C25MF10
RJ 45	M-M	10	C45M10	M-M	20	C45M20
6P Mini Din	M-M	3	C6M3	M-M	6	C6M6
		10	C6M10			
8P Mini Din	M-M	3	C8M3	M-M	6	C8M3
		10	C8M10			
USB	M-M	3	CUM3	M-M	6	CUM6
		10	CUM10			
RJ45 CAT 5	M-M	10	C455M10			

Remote Access Ports

Custom Configurations

Section 1: Enclosures:

	<input checked="" type="checkbox"/> Description:	Part #:	<input checked="" type="checkbox"/> Description:	Part #:	<input checked="" type="checkbox"/> Description:	Part #:
	<input type="checkbox"/> HBE 6 Enclosure	6	<input type="checkbox"/> HBE 24 Enclosure	24	<input type="checkbox"/> CD-ROM Housing	10.9000
	<input type="checkbox"/> HBE 10 Enclosure	10	<input type="checkbox"/> HBE 32 Enclosure	32	* Note: Available in surface mount bases.	
	<input type="checkbox"/> HBE 16 Enclosure	16	<input type="checkbox"/> HBE 48 Enclosure	48		

Section 2: Components:

D'SUBMINIATURES

Qty:	<input checked="" type="checkbox"/> Description:	Part #:	Gender:	Termination:	Pass Through Configuration:
—	<input type="checkbox"/> DB 9 = DH+, DH 485, M984	9	<input type="checkbox"/> M <input type="checkbox"/> F	<input type="checkbox"/> T <input type="checkbox"/> S <input type="checkbox"/> P	_____
—	<input type="checkbox"/> DB 15= PLC 2	15	<input type="checkbox"/> M <input type="checkbox"/> F	<input type="checkbox"/> T <input type="checkbox"/> S <input type="checkbox"/> P	_____
—	<input type="checkbox"/> DB 15 High Density= Video, VGA	15H	<input type="checkbox"/> M <input type="checkbox"/> F	<input type="checkbox"/> T <input type="checkbox"/> S <input type="checkbox"/> P	_____
—	<input type="checkbox"/> DB 25= RS232, Parallel, Printer, PLC3	25	<input type="checkbox"/> M <input type="checkbox"/> F	<input type="checkbox"/> T <input type="checkbox"/> S <input type="checkbox"/> P	_____
—	<input type="checkbox"/> DB 37=	37	<input type="checkbox"/> M <input type="checkbox"/> F	<input type="checkbox"/> T <input type="checkbox"/> S <input type="checkbox"/> P	_____

Terminal Block Interface (T), Solder Cup (S), Pass-Through (P) (specify genders)

AC OUTLETS

	<input checked="" type="checkbox"/> Description:	Part #:
	<input type="checkbox"/> Single AC Outlet	1
	<input type="checkbox"/> Single AC Outlet Slim	1S
	<input type="checkbox"/> Single AC Plug	1M
	<input type="checkbox"/> Duplex AC Outlet	2
	<input type="checkbox"/> Duplex Outlet w/Screw Term	2S
	<input type="checkbox"/> GFCI: Ground Fault Circuit Interrupt	G2
	<input type="checkbox"/> European Outlet	GAC

PERIPHERAL DEVICES

	<input checked="" type="checkbox"/> Description:	Part #:
	<input type="checkbox"/> 3.5" Disk Drive Bracket with Drive	35DD
	<input type="checkbox"/> 3.5" Disk Drive Bracket without Drive	35ND
	<input type="checkbox"/> CD-Rom Bracket with drive	CDR
	<input type="checkbox"/> CD-Rom Bracket without drive	NCDR
	<input type="checkbox"/> Zip Drive Bracket with Drive	ZIPDD
	<input type="checkbox"/> Zip Drive Bracket without Drive	ZIPND
	<input type="checkbox"/> 3.5" Disk Drive/ CD-Rom Drive	DD-CD

MINI DIN COUPLERS

	<input checked="" type="checkbox"/> Description:	Part #:
	<input type="checkbox"/> 6 Pos Mini Din Coupler	MD6P
	<input type="checkbox"/> 8 Pos Mini Din= SLC5/04, Data Highway+, Enhanced PLC5	MD8P
	<input type="checkbox"/> Terminal Block Interface	T

CIRCUIT BREAKERS

	<input checked="" type="checkbox"/> Description:	Part #:
	<input type="checkbox"/> 1 Amp Circuit Breaker	1A
	<input type="checkbox"/> 2 Amp Circuit Breaker	2A
	<input type="checkbox"/> 3 Amp Circuit Breaker	3A
	<input type="checkbox"/> 5 Amp Circuit Breaker	5A

DIN COUPLERS

	<input checked="" type="checkbox"/> Description:	Part #:
	<input type="checkbox"/> 5 Pos Din Coupler= AT style keyboard	D5P
	<input type="checkbox"/> Terminal Block Interface	T

PHONE JACKS

	<input checked="" type="checkbox"/> Description:	Part #:
	<input type="checkbox"/> RJ 45 Coupler= DH 485, SLC 500 Ethernet, Control Net, 10 Base	45C
	<input type="checkbox"/> RJ 45 Shielded Coupler	45CS
	<input type="checkbox"/> RJ 45 CAT5	45C5
	<input type="checkbox"/> RJ 45 Shielded CAT5	45C5S
	<input type="checkbox"/> RJ 11 Coupler	11C
	<input type="checkbox"/> RJ 11 Shielded Coupler	11CS
	<input type="checkbox"/> Terminal Block Interface	T

LOCKS

	<input checked="" type="checkbox"/> Description:	Part #:
	<input type="checkbox"/> Electrical / Switch Lock	L
	<input type="checkbox"/> Cover Lock Out	LO

3 POSITION HEADER

	<input checked="" type="checkbox"/> Description:	Part #:
	<input type="checkbox"/> 3 Pos Header = Data Highway +	3H
	<input type="checkbox"/> 5 Pos Header	5H

FIBER OPTIC COUPLERS

Fiber Optic Coupler: Specify type: _____

USB PORTS

USB Port UFP

Other Components Available. Specify your requirements: _____

Cable Assemblies:

Ports may be ordered prewired with cable sets. Add CX to the end of the component part number which should be prewired. Replace the X with the desired cable length in feet. See previous page.

Part Numbers:

Section 1: Enclosure

Section 2: Components and Cable Assemblies

Example: HBE 48 Enclosure with Duplex AC Outlet, 25 Pos Male D'Sub with 10' of cable, 3 Amp Circuit Breaker (Part # 48-2-25MC10-3A)